

Generating Links to Videos from the Content Home Page

To generate a public link to a video from your Content Home

If necessary, click **My Content** from the left side of the Echo Home page to view all the content you own in your echo library.

1. Login in to Echo360.org
2. Use the Filters and/or Search box to find the item you want to create a link for.
3. Hover over the media tile and CLICK the **Menu** button. (Seen as blue square with 3 white dots)
4. Select **Share** from the media options menu, as shown in the below figure.

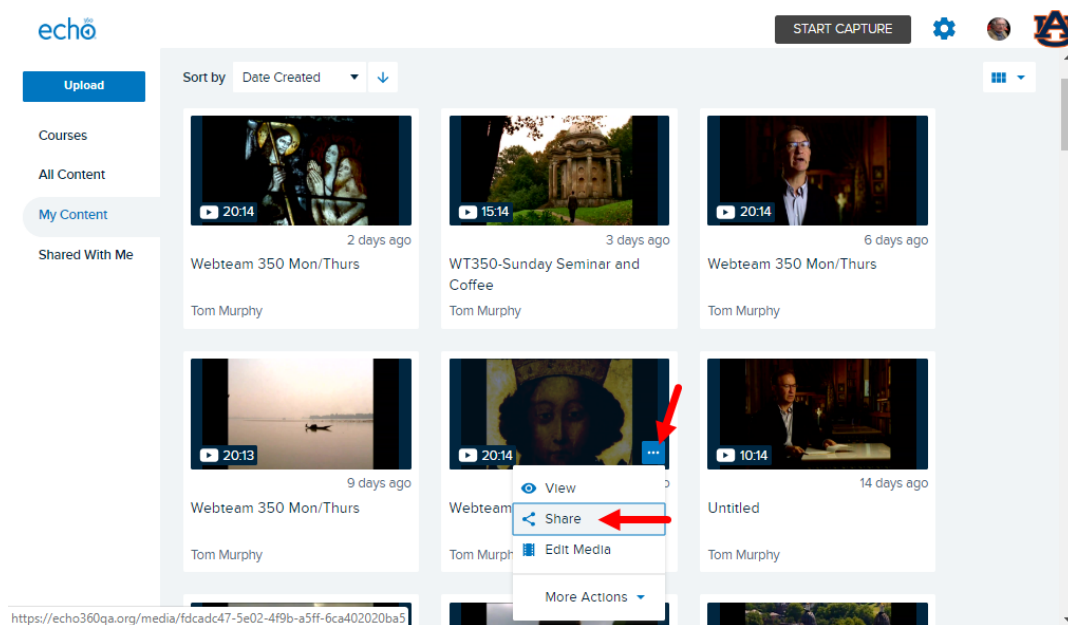

5. The Individual tab appears by default. Click the **Links** tab at the top

6.

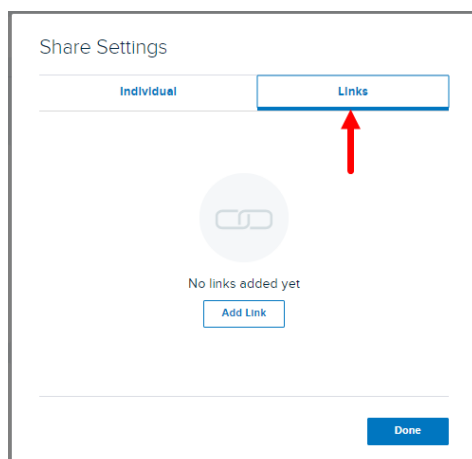

7. Click the **Add Link** button, if no links have been previously made. If links exist, move to next step.

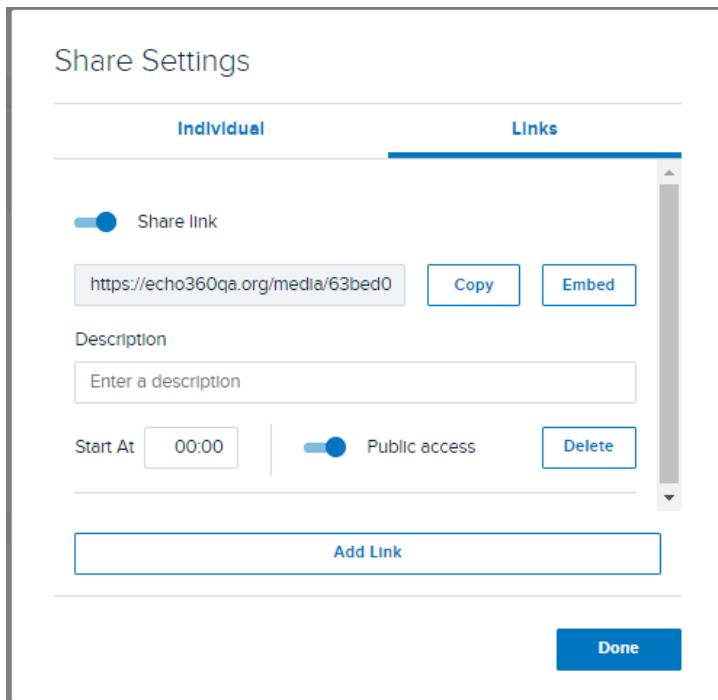

The screenshot shows the 'Share Settings' dialog box with the 'Links' tab selected. The 'Share Link' toggle is turned on. A text box contains the URL 'https://echo360qa.org/media/63bed0', with 'Copy' and 'Embed' buttons to its right. Below this is a 'Description' field with the placeholder text 'Enter a description'. Further down, there is a 'Start At' field set to '00:00', a 'Public access' toggle which is turned on, and a 'Delete' button. At the bottom of the dialog, there is an 'Add Link' button and a 'Done' button.

**At this time you have 2 choices, either Copy and Paste the URL link into D2L or you can Copy and Paste the Embed Code and have the video embedded directly into D2L. Either is fine and both work great. Keep in mind that if you decide to use the embed code you can use D2L's built in analytics to track and see video usage by your students.

7. If wanted, click **EMBED** to generate embed code around the link for embedding into D2L
8. In the Embed link dialog box, you can select **Size** options for the embedded frame,

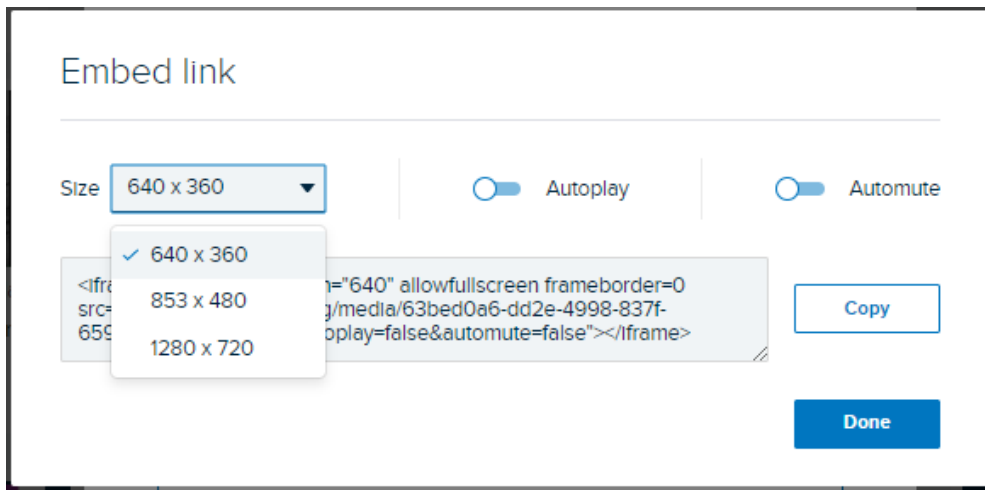

9. Once the embed options are configured, click **Copy** to **copy the full embed code to your clipboard** for pasting to the desired location.
10. Click **Done** to close the Embed link dialog box and return to the Links list.
11. When finished generating links to the content, click **Done** at the bottom of the Share settings modal.

You are now ready to paste the link into your D2L course content.